

FORM NO 1.

York County Shore

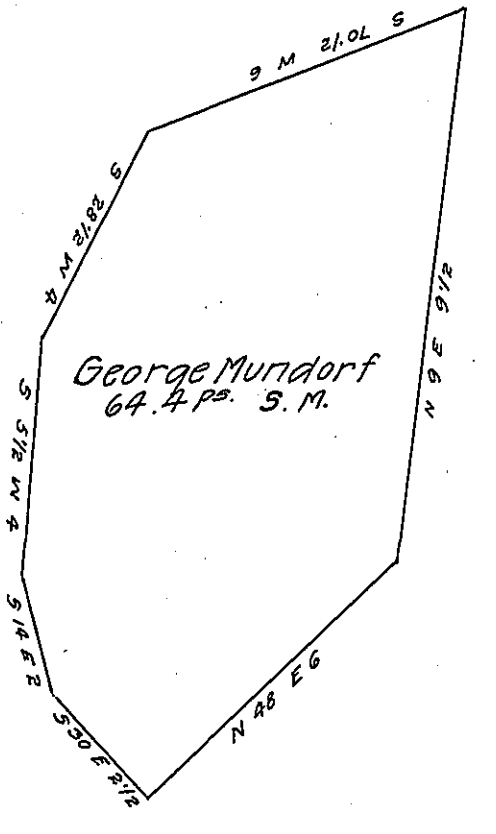

Lancaster County Shore

A Draught of Scraping rock Island situate in the river Susquehanna in Conestoga township Lancaster County about seventy or eighty perches from Burckholders Island opposite land of Joseph Reed on the York County Shore Containing sixty four perches & four tenths Strict measure Surveyed in pursuance of a warrant dated 21<sup>st</sup> day of September 1818 granted to George Mundorf

Jacob Hibshman D.S.

To Jacob Spangler Esq.  
Surveyor General.

IN TESTIMONY that the above is a copy of the original remaining on file in the Department of Internal Affairs of Pennsylvania, made conformably to an Act of Assembly approved the 16th day of February, 1833, I have hereunto set my Hand and caused the Seal of said Department to be affixed at Harrisburg, this thirtieth day of November 1907.

*Henry Howell*  
Secretary of Internal Affairs.